

Insta360 ONE X2 Dive Case

Instructions for Use / 使用说明

Specifications

Maximum water depth: 45m (147.6ft)

Included items: Insta360 ONE X2 Dive Case, Anti-fog Inserts, 1/4" Mount Adapter, 1/4" Thumb Screw, Protective Pouch, Stabilizer Ring, Thumb Screw Wrench, Instructions & Warranty

Weight: 131g

Names of Parts

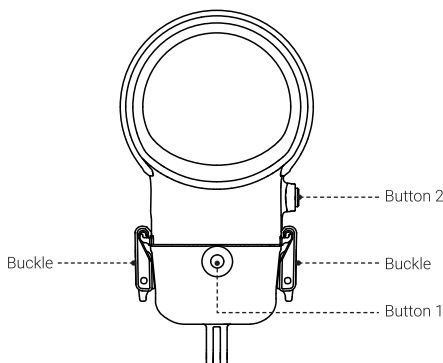

Before Using

① Please read this document carefully and prepare the case properly before use.

Failure to observe these instructions may cause damage to the camera, battery, microSD card or other parts, for which Insta360 won't assume responsibility. Please use this product responsibly to prevent accidental damage.

② Improper maintenance may affect product performance. Each time before placing the camera in the Dive Case, it's suggested to latch the Dive Case (no camera inserted) and immerse it in water to check for leaks as described below.

- Latch the Dive Case and then slowly immerse it in water, stopping if air is expelled from inside the Dive Case.

- Immerse the Dive Case and operate the buttons under water for 2-3 minutes, checking for any air bubbles.

- Take the Dive Case out of the water and dry it thoroughly with a soft, dry cloth, then open the Dive Case and check for water inside.

③ When sealing the Dive Case, be sure that the parts of the Dive Case in contact with its rubber seal are free of any foreign objects and the rubber seal has not moved off the rim of the Dive Case.

④ Never open or close the Dive Case in a location with a lot of sand, dirt, dust or other small particles. Otherwise, the performance of the Dive Case will be reduced and the camera may be damaged.

⑤ The Dive Case is not shock-resistant. Applying strong vibrations, shocks or pressure to the product may result in damage, failure or reduced waterproofing performance. While using ONE X2 in the Dive Case, the maximum height from which you can dive into water is 2 meters (6.56ft). The Dive Case is protected against drops onto solid ground from a maximum height of 1 meter (3.28ft).

⑥ Glue may be visible inside the outer edge of the Dive Case lenses. This is normal and will not affect waterproofing performance.

How to Use

① Open the Case

Lift the buckle as shown below (①), then pull it down to remove from the hook (②). Repeat with the other buckle. When both sides are disengaged, open the Dive Case.

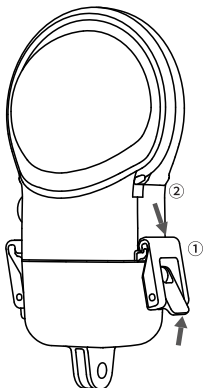

② Attach the Anti-Fog Inserts

Ensure that two anti-fog inserts are inserted as shown below.

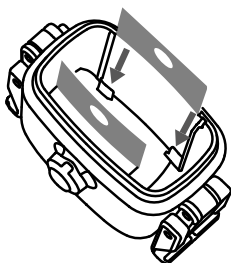

Note:

- 1) When installing anti-fog inserts, align their holes so that the inserts do not cover the camera's status indicators.
- 2) When using third-party anti-fog inserts, ensure that the size is within $32 \times 18 \times 1$ mm. If the inserts are too large, they will cause water leakage and potentially damage the camera.

③ Insert the Camera

■ Install the Dive Case's lower cover

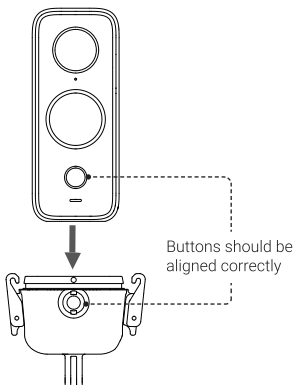

■ Install the Dive Case's upper cover

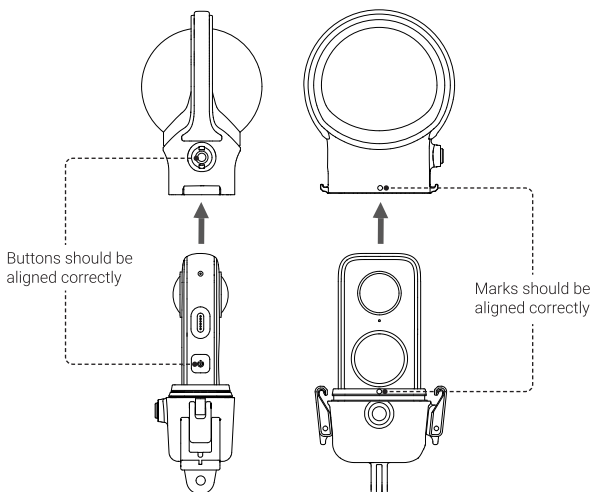

Note:

- 1) When using the camera in water, please lock the touch screen to avoid accidental presses.
- 2) When inserting the camera, take care not to scratch the lens.

4 Close the Case

To close the Dive Case, latch the buckle onto the case's hook and firmly push down until it clicks.

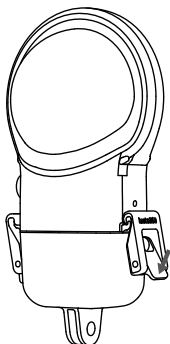

Note:

- 1) Ensure the Dive Case is firmly closed. Be sure that the parts of the Dive Case in contact with its rubber seal are free of dirt or dust.
- 2) For the best results, keep the lenses of the Dive Case clean.

5 Attach the Stabilizer Ring

When connecting the Dive Case to other accessories, such as the floating hand grip, be sure to stick a stabilizer ring to the screw points.

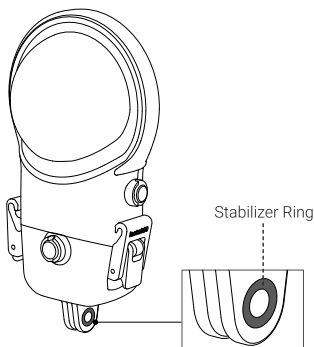

6 Stitch

After capturing with the Dive Case, connect ONE X2 to your phone, open files taken with the Dive Case in the app and select Stitch for Dive Case.

Maintenance

- ① Do not open the Dive Case while it is wet.
- ② After using the product in seawater, take out ONE X2, and soak the Dive Case in fresh water for at least 60 minutes. If the Dive Case is not rinsed after use in seawater, residual salt may crystalize in gaps. These salt crystals will not dissolve in water and can lift up the rubber seal and cause water leakage. After soaking the Dive Case in fresh water, rinse it under gently flowing tap water. Never apply a strong water stream from a single direction, as it may cause water leakage.
- ③ Ensure that the Dive Case is firmly closed before washing. After washing the Dive Case, wipe away any water droplets remaining on the surface with a soft, dry cloth. Do not dry it with a hair dryer, clothes dryer or stove.
- ④ Ensure there is no sand on the Dive Case before drying. Sand may scratch the product surface when wiped with a cloth.
- ⑤ Do not store the Dive Case in a hot and humid environment. In particular, do not leave it inside a hot car.
- ⑥ Do not wash the Dive Case with soap, neutral detergent or alcohol cleaning products. This may degrade the waterproofing performance.
- ⑦ Store the product in a dry, well-ventilated location.

After-sales Service

The warranty period of the attached product is 1 year from the original retail purchase. Warranty service may vary according to the applicable laws of your state or jurisdiction. For detailed warranty policies, please visit <http://insta360.com/support>.

* Within the scope of national laws and regulations, Arashi Vision Inc. ("Insta360") reserves the right of final interpretation for the instructions and other files, which are subject to change without prior notice.

规格

最大防水深度：45 米

包含物品：Insta360 ONE X2 潜水壳、防雾片、1/4 螺丝转接头、1/4 螺丝固定杆、扳手、便携收纳袋、防松片、使用说明 & 保修（本文档）

重量：131 克

部件名称

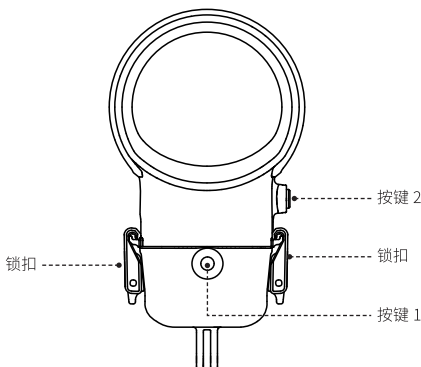

使用前

① 请仔细阅读本文档，并确保在使用前进行准备和维护。如果不遵循使用指南进行操作，可能会导致相机、电池、记录内容等损失，本公司不承担任何责任。您有责任以谨慎合理的方式使用本产品。

② 由于维护方法不当可能会导致产品性能受影响，建议在每次使用前，请先将潜水壳（空壳）锁好，然后浸入水中检查是否漏水，具体如下：

- 将潜水壳锁好，然后慢慢浸入水中，如果有空气从潜水壳内排出则停止操作。
- 将潜水壳浸泡在水中并操作按键 2~3 分钟，检查是否有气泡出现。
- 将潜水壳从水中取出，用柔软的干布擦拭干净，然后打开潜水壳并仔细检查内部是否有水进入。

③ 密封潜水壳前，请确保密封圈及其接触表面上没有异物（污垢、灰尘、沙子、毛发、棉绒、液体等）。确保密封圈没有扭曲、错位、划痕、裂缝等。

④ 切勿在有大量沙子、污垢、灰尘等的场所打开和关闭保护壳。若不遵循此注意事项可能会导致异物粘附在密封圈上，从而降低产品性能，损坏相机。

⑤ 为保证潜水壳密封性，关闭外壳后，请再次确认密封圈未被挤出或无异物卡在潜水壳内。

⑥ 本产品不耐冲击。对产品施加剧烈的震动、冲击或压力可能会导致损坏或降低潜水壳防水性能。使用时，跳水高度请限制在 2 米内，跌落高度（水泥地板）1 米内。

⑦ 潜水壳镜片与壳体固定处如有气泡状残留胶水，属于正常现象，不影响防水性能。

① 打开潜水壳

按图示向上推动潜水壳锁栓（①），取下挂扣（②）。同理，打开另一侧锁扣，即可打开潜水壳。

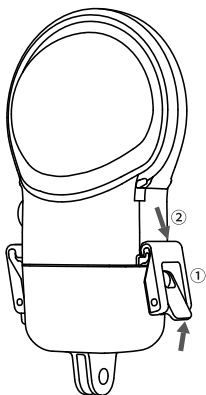

② 放置防雾片

将防雾片分别放置在潜水壳底盖内壁两侧，确保防雾片嵌在潜水壳如图所示位置。

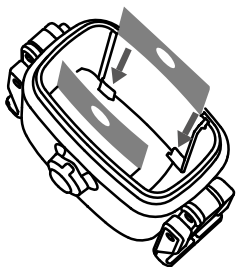

注意！

- 1) 置入防雾片时，请注意防雾片中心的圆孔与相机状态指示灯的对应，避免相机状态指示灯被防雾片遮盖。
- 2) 如购买第三方防雾片，请确保防雾片尺寸小于或等于 32 x 18 x 1 mm。防雾片尺寸过大会导致潜水壳密封不良，损毁相机。

③ 置入相机

■ 安装潜水壳底盖

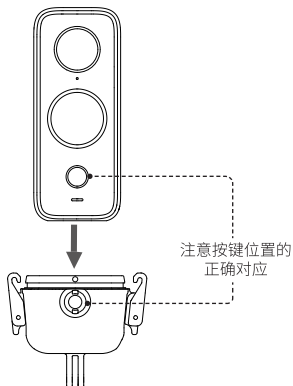

■ 安装潜水壳上盖

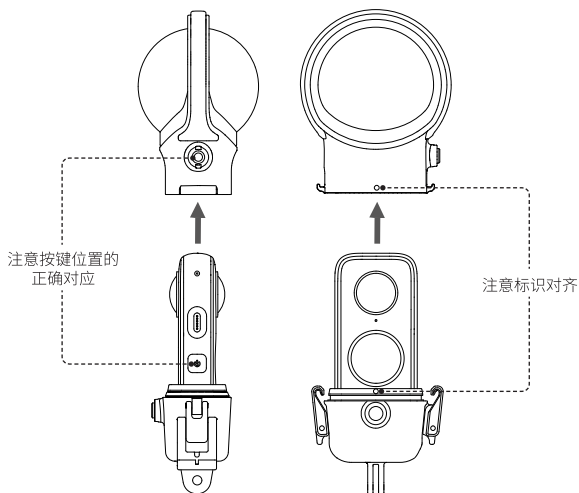

注意!

- 1) 当相机在水下使用时, 请使用锁屏功能, 将屏幕锁定, 以防误触屏幕。此时, 可使用侧边按键切换拍摄模式。
- 2) 置入相机时, 请注意不要划伤镜头。

④ 关闭潜水壳

关闭潜水壳，分别将潜水壳两侧的挂钩锁合至挂耳，然后按下锁栓，直至发出咔嚓声。

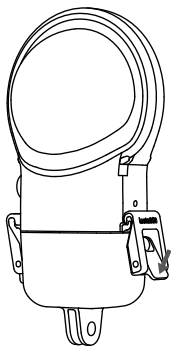

注意！

- 1) 仔细检查潜水壳是否牢固关闭，确保密封圈及其接触表面没有污垢或灰尘。
- 2) 为了获得最佳拍摄效果，使用时请保持潜水壳镜片的干净。

⑤ 安装防松垫片

将潜水壳转接至其他配件时，为更好固定转接底座，使用时可在接口处粘贴透明防松垫片。

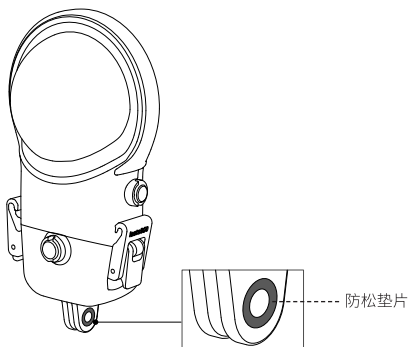

⑥ 拼接

使用潜水壳完成拍摄后，将相机与手机连接，在 app 中打开拍摄内容，选择潜水壳拼接即可。

维护

- ① 潜水壳潮湿时，请勿打开。
- ② 在海水环境中使用产品后，请先打开潜水壳取出相机，然后关闭潜水壳将其放入清水（淡水）中浸泡至少 60 分钟以上。如果产品在海水使用后没有冲洗，残留的盐分会在缝隙中结晶，并形成不溶于水的晶体。这些盐晶会顶起密封圈，导致产品进水。因此，请务必将产品在淡水中浸泡。从淡水中取出产品后，在柔和流动的自来水中进行冲洗。不要从单一方向施加强力的水流，因为这可能会导致产品进水。
- ③ 在用水清洗产品之前，请确保潜水壳牢固关闭。清洗产品后，用干毛巾擦去产品表面上残留的水滴。请勿使用烘干机或炉子进行烘干。
- ④ 用布擦拭时，粘附在产品上的沙子可能会刮伤产品表面。
- ⑤ 请勿将产品存放在炎热潮湿的环境中。特别是，请勿将产品留在汽车内。
- ⑥ 请勿用肥皂水、中性清洁剂或酒精清洗产品。这可能会降低防水性能。
- ⑦ 请勿使用有机溶剂（如稀释剂、酒精或汽油）进行清洁。
- ⑧ 请将产品存放在干燥、通风良好的场所。

售后服务

自您最初零售购入之日起，本产品的保修期为 1 年。详细的售后服务流程和保修条款，请访问 <https://www.insta360.com/support>

* 在国家法律法规的范围内，Insta360 ONE X2 潜水壳使用注意事项及其他文档最终的解释权归影石创新科技股份有限公司（“Insta360”）所有，如有更新，恕不另行通知。

Arashi Vision Inc.

ADD: 6F, Building A, Logan Century Center, 23 Haixiu Road,
Bao'an District, Shenzhen, Guangdong, China

WEB: www.insta360.com

TEL: 400-833-4360 +1 800 6920 360

EMAIL: service@insta360.com

V1.0